

# TERRA LANA WOOL INSULATION PRODUCT SPECIFICATIONS & DATA

Specification Table

Skillion Ceiling data sheet

Truss Ceiling data sheet

Timber I-Beam Fillet data sheet

Exterior Wall data sheet

Service Cavity data sheet

Drop In Floor data sheet

Underfloor data sheet

Chatterblock Acoustic data sheet

Acoustic specifications

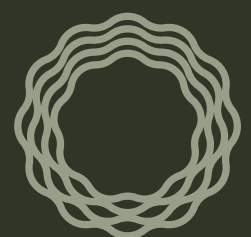

**TERRA LANA**

# TERRA LANA WOOL INSULATION SPECIFICATION TABLE

All products are available in customised widths, lengths and R-values for orders over 50m<sup>2</sup>

| R-VALUE  | THICKNESS | CENTRES       | GSM      | DENSITY                | λ-VALUE                   | CODE        |
|--|-----------|---------------|----------|------------------------|---------------------------|-------------|
| <b>CEILING SERVICE CAVITY</b>  |           |               |          |                        |                           |             |
| R0.9   | 35mm      | 600mm         | 1000 gsm | 28.6 kg/m <sup>3</sup> | 0.0389 W/m <sup>2</sup> K | 09.35.570   |
| R1.2   | 45mm      | 600mm         | 1200 gsm | 26.7 kg/m <sup>3</sup> | 0.0375 W/m <sup>2</sup> K | 12.45.570   |
| R2.4   | 90mm      | 600mm         | 2600 gsm | 28.9 kg/m <sup>3</sup> | 0.0375 W/m <sup>2</sup> K | 24.90.560   |
| <b>SKILLION ROOF</b> – Can also be used in Truss roof  |           |               |          |                        |                           |             |
| R3.6   | 140mm     | 600mm         | 3700 gsm | 26.4 kg/m <sup>3</sup> | 0.0389 W/m <sup>2</sup> K | 36.140.560  |
| R5.0   | 190mm     | 600mm         | 5700 gsm | 30.0 kg/m <sup>3</sup> | 0.0380 W/m <sup>2</sup> K | 50.190.570  |
| R6.4   | 240mm     | 600mm         | 7400 gsm | 30.8 kg/m <sup>3</sup> | 0.0375 W/m <sup>2</sup> K | 64.240.570  |
| R7.2   | 290mm     | 600mm         | 6800 gsm | 23.4 kg/m <sup>3</sup> | 0.0403 W/m <sup>2</sup> K | 72.290.570  |
| <b>TIMBER I-BEAM RAFTER 'FILLET'</b> – Custom fillets available for all hyJOIST and Lumberworx I-Beams – see our website |           |               |          |                        |                           |             |
| R0.9   | 35mm      | 200mm hyJOIST | 1000 gsm | 28.6 kg/m <sup>3</sup> | 0.0389 W/m <sup>2</sup> K | 09.35.120F  |
| R0.9   | 35mm      | 240mm hyJOIST | 1000 gsm | 28.6 kg/m <sup>3</sup> | 0.0389 W/m <sup>2</sup> K | 09.35.160F  |
| <b>TRUSS ROOF</b>  |           |               |          |                        |                           |             |
| R3.6   | 180mm     | 900mm         | 2600 gsm | 14.4 kg/m <sup>3</sup> | 0.0500 W/m <sup>2</sup> K | 36.180.435  |
| R4.0   | 190mm     | 900mm         | 3000 gsm | 15.8 kg/m <sup>3</sup> | 0.0475 W/m <sup>2</sup> K | 40.190.435  |
| <b>TRUSS ROOF DOUBLE LAYER</b>   |           |               |          |                        |                           |             |
| R5.2 (R2.6 + R2.6)   | 290 mm    | 900mm         | 3420 gsm | 11.8 kg/m <sup>3</sup> | 0.0558 W/mK               | 26.145.435  |
| R6.4 (R3.2 + R3.2)   | 330 mm    | 900mm         | 4400 gsm | 13.3 kg/m <sup>3</sup> | 0.0516 W/mK               | 32.165.435  |
| R7.2 (R3.6 + R3.6)   | 360mm     | 900mm         | 5200 gsm | 14.4 kg/m <sup>3</sup> | 0.0500 W/mK               | 36.180.435  |
| R8.0 (R4.0 + R4.0)   | 380mm     | 900mm         | 6000 gsm | 15.8 kg/m <sup>3</sup> | 0.0475 W/mK               | 40.190.435  |
| <b>WALL SERVICE CAVITY</b>   |           |               |          |                        |                           |             |
| R1.2   | 45mm      | 600mm         | 1200 gsm | 26.7 kg/m <sup>3</sup> | 0.0375 W/m <sup>2</sup> K | 12.45.570   |
| <b>90mm WALL</b>   |           |               |          |                        |                           |             |
| R2.4   | 90mm      | 400mm         | 2600 gsm | 28.9 kg/m <sup>3</sup> | 0.0375 W/m <sup>2</sup> K | 24.90.360   |
| R2.4   | 90mm      | 600mm         | 2600 gsm | 28.9 kg/m <sup>3</sup> | 0.0375 W/m <sup>2</sup> K | 24.90.560   |
| <b>140mm WALL</b>  |           |               |          |                        |                           |             |
| R3.2   | 140mm     | 400mm         | 2600 gsm | 18.6 kg/m <sup>3</sup> | 0.0438 W/m <sup>2</sup> K | 32.140.360  |
| R3.2   | 140mm     | 600mm         | 2600 gsm | 18.6 kg/m <sup>3</sup> | 0.0438 W/m <sup>2</sup> K | 32.140.560  |
| R3.6   | 140mm     | 400mm         | 3700 gsm | 26.4 kg/m <sup>3</sup> | 0.0389 W/m <sup>2</sup> K | 36.140.360  |
| R3.6   | 140mm     | 600mm         | 3700 gsm | 26.4 kg/m <sup>3</sup> | 0.0389 W/m <sup>2</sup> K | 36.140.560  |
| <b>CHATTERBLOCK ACOUSTIC</b> – For internal walls and midfloor   |           |               |          |                        |                           |             |
| R1.4   | 60mm      | 600mm         | 2800 gsm | 46.7 kg/m <sup>3</sup> | 0.0430 W/m <sup>2</sup> K | CB.60.560   |
| R2.2   | 90mm      | 600mm         | 1960 gsm | 21.8 kg/m <sup>3</sup> | 0.0640 W/m <sup>2</sup> K | CB.90.560   |
| R3.2   | 140mm     | 600mm         | 2550 gsm | 18.2 kg/m <sup>3</sup> | 0.0438 W/m <sup>2</sup> K | CB.140.560  |
| <b>RETRO-FIT UNDERFLOOR</b> – Stapled in from underneath   |           |               |          |                        |                           |             |
| R2.0   | 115mm     | 450mm         | 1200 gsm | 10.4 kg/m <sup>3</sup> | 0.0575 W/m <sup>2</sup> K | 20.115.480  |
| <b>NEW BUILD DROP-IN UNDERFLOOR</b> – Install from above with propriety fastening system, prior to sheet flooring        |           |               |          |                        |                           |             |
| R2.7   | 110mm     | 400mm         | 3300 gsm | 30.0 kg/m <sup>3</sup> | 0.0407 W/m <sup>2</sup> K | DIF.110.365 |
| R3.2   | 140mm     | 400mm         | 3500 gsm | 25.0 kg/m <sup>3</sup> | 0.0438 W/m <sup>2</sup> K | DIF.140.365 |



0800 485 262

spec@terralana.co.nz | terralana.co.nz

55 Francella St, Christchurch, NZ



TERRA LANA

# SKILLION ROOF WOOL INSULATION



TERRA LANA

## PRODUCT DATA

The benefits of Terra Lana wool's superior performance designed for Skillion ceilings

### APPLICATIONS

- Skillion roof  
(Truss roof or external walls where applicable)
- New and retrofit
- Residential and commercial buildings

### FEATURES

- Designed to not slump or lose loft
- Superior insulative performance
- 100% recyclable (by Terra Lana)
- Easy to install, manufactured to fit
- Environmentally responsible product
- Naturally safe to handle & healthy in the home
- Manages moisture, maintaining thermal performance
- Excellent acoustic barrier qualities.

### DESCRIPTION

Terra Lana harnesses all the benefits of wool's unique insulative qualities combined with innovative design for a truly high-performance skillion roof insulation. We use natural and recycled materials and manufacture locally to modern sustainability standards.

### COMPLIANCE

- BRANZ APPRAISED. Appraisal 682 [2022]
- DECLARE RED LIST FREE. Certified toxin free
- GREENGUARD. Indoor air quality test approved
- HOMESTAR/GREENSTAR. Credits available
- EPD (in process for mid 2024 completion)
- QUALITY ASSURANCE. 50 year warranty

### SPEC ASSIST

- Masterspec
- Smart Spec
- Design Navigator
- H1 Reports & spec writing

Contact: [spec@terralana.co.nz](mailto:spec@terralana.co.nz)

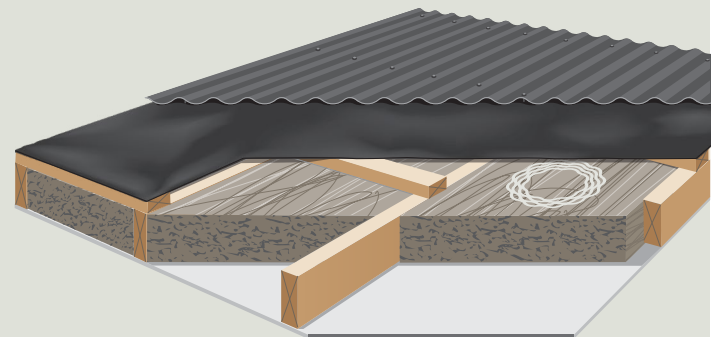

### SPECIFICATIONS

| R-VALUE                           | THICKNESS | CENTRES | BALE CONTAINS     | M <sup>2</sup> PER BALE | CODE       |
|-----------------------------------|-----------|---------|-------------------|-------------------------|------------|
| CEILING SERVICE CAVITY INSULATION |           |         |                   |                         |            |
| R0.9                              | 35mm      | 600mm   | 2 x 6m x 570mm    | 6.84 m <sup>2</sup>     | 09.35.570  |
| R1.2                              | 45mm      | 600mm   | 2 x 5m x 570mm    | 5.70 m <sup>2</sup>     | 12.45.570  |
| R2.4                              | 90mm      | 600mm   | 10 x 1.2m x 560mm | 6.72 m <sup>2</sup>     | 24.90.560  |
| SKILLION ROOF INSULATION          |           |         |                   |                         |            |
| R3.6                              | 140mm     | 600mm   | 8 x 1.2m x 560mm  | 5.38 m <sup>2</sup>     | 36.140.560 |
| R5.0                              | 190mm     | 600mm   | 5 x 1.2m x 570mm  | 3.42 m <sup>2</sup>     | 50.190.570 |
| R6.4                              | 240mm     | 600mm   | 4 x 1.2m x 570mm  | 2.74 m <sup>2</sup>     | 64.240.570 |
| R7.2                              | 290mm     | 600mm   | 4 x 1.2m x 570mm  | 2.74 m <sup>2</sup>     | 72.290.570 |



0800 485 262 | [sales@terralana.co.nz](mailto:sales@terralana.co.nz) | [terralana.co.nz](http://terralana.co.nz)

# TRUSS ROOF WOOL INSULATION



TERRA LANA

## PRODUCT DATA

The benefits of Terra Lana wool's superior performance designed for Truss roof ceilings

### APPLICATIONS

- Truss roof (Skillion roof or external walls where applicable)
- New and retrofit
- Residential and commercial buildings

### FEATURES

- Designed to not slump or lose loft
- Superior insulative performance
- 100% recyclable (by Terra Lana)
- Easy to install, manufactured to fit
- Environmentally responsible product
- Naturally safe to handle & healthy in the home
- Manages moisture, maintaining thermal performance
- Excellent acoustic barrier qualities.

### DESCRIPTION

Terra Lana harnesses all the benefits of wool's unique insulative qualities combined with innovative design for a truly high-performance truss roof insulation. We use natural and recycled materials and manufacture locally to modern sustainability standards.

### COMPLIANCE

- BRANZ APPRAISED. Appraisal 682 [2022]
- DECLARE RED LIST FREE. Certified toxin free
- GREENGUARD. Indoor air quality test approved
- HOMESTAR/GREENSTAR. Credits available
- EPD (in process for mid 2024 completion)
- QUALITY ASSURANCE. 50 year warranty

### SPEC ASSIST

- Masterspec
- Smart Spec
- Design Navigator
- H1 Reports & spec writing

Contact: [spec@terralana.co.nz](mailto:spec@terralana.co.nz)

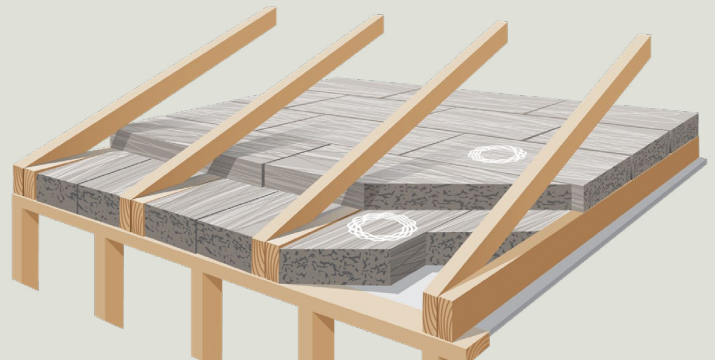

### SPECIFICATIONS

| R-VALUE                            | THICKNESS | CENTRES | BALE CONTAINS     | M <sup>2</sup> PER BALE | CODE       |
|------------------------------------|-----------|---------|-------------------|-------------------------|------------|
| CEILING SERVICE CAVITY INSULATION  |           |         |                   |                         |            |
| R0.9                               | 35mm      | 600mm   | 2 x 6m x 570mm    | 6.84 m <sup>2</sup>     | 09.35.570  |
| R1.2                               | 45mm      | 600mm   | 2 x 5m x 570mm    | 5.70 m <sup>2</sup>     | 12.45.570  |
| R2.4                               | 90mm      | 600mm   | 10 x 1.2m x 560mm | 6.72 m <sup>2</sup>     | 24.90.560  |
| TRUSS ROOF INSULATION              |           |         |                   |                         |            |
| R3.6                               | 180mm     | 900mm   | 10 x 1.2m x 435mm | 5.22 m <sup>2</sup>     | 36.180.435 |
| R4.0                               | 190mm     | 900mm   | 10 x 1.2m x 435mm | 5.22 m <sup>2</sup>     | 40.190.435 |
| TRUSS ROOF DOUBLE LAYER INSULATION |           |         |                   |                         |            |
| R5.2 (R2.6 + R2.6)                 | 290mm     | 900mm   | 12 x 1.2m x 435mm | 3.13 m <sup>2</sup>     | 26.145.435 |
| R6.4 (R3.2 + R3.2)                 | 330mm     | 900mm   | 10 x 1.2m x 435mm | 2.61 m <sup>2</sup>     | 32.165.435 |
| R7.2 (R3.6 + R3.6)                 | 360mm     | 900mm   | 10 x 1.2m x 435mm | 2.61 m <sup>2</sup>     | 36.180.435 |
| R8.0 (R4.0 + R4.0)                 | 380mm     | 900mm   | 10 x 1.2m x 435mm | 2.61 m <sup>2</sup>     | 40.190.435 |



0800 485 262 | [sales@terralana.co.nz](mailto:sales@terralana.co.nz) | [terralana.co.nz](http://terralana.co.nz)

# TIMBER I-BEAM FILLET WOOL INSULATION



TERRA LANA

## PRODUCT DATA

The natural benefits of Terra Lana wool for optimal insulation of timber I-Beam systems

### APPLICATIONS

- hyJOIST rafters/joists
- Lumberworx rafters/joists

### FEATURES

- The only specific solution available for timber I-Beams
- Maximises thermal performance of timber I-Beams
- Custom made to fit all timber I-Beam sizes
- Easy to install, manufactured to friction fit
- Environmentally responsible product
- Naturally safe to handle & healthy in the home
- 100% recyclable (by Terra Lana)

### COMPLIANCE

- BRANZ APPRAISED. Appraisal 682 [2022]
- DECLARE RED LIST FREE. Certified toxin free
- GREENGUARD. Indoor air quality test approved
- HOMESTAR/GREENSTAR. Credits available
- EPD. (in process for mid 2024 completion)
- QUALITY ASSURANCE. 50 year warranty
- H1 COMPLIANT. Designed to meet/exceed

**SPEC ASSIST** – Contact: [spec@terralana.co.nz](mailto:spec@terralana.co.nz)

- Masterspec
- Smart Spec
- Design Navigator
- H1 Reports & spec writing

### DESCRIPTION

Timber I-Beams are often specified over standard solid timber framing to reduce thermal bridging and increase span capacity.

I-Beam's create voids that are difficult to insulate using standard insulation products. Terra Lana timber I-Beam fillets friction-fit within the voids to ensure maximum thermal performance.

#### Note

When specifying vapour control layers, such as Pro Clima Intello, directly beneath rafters, consider spacing rafters at 600mm centres max. This will ensure the insulation can friction fit and be stapled to the edge of the rafter, without applying excessive pressure on the vapour control layer, or falling out of the cavity.

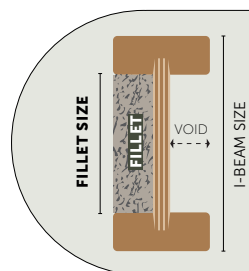
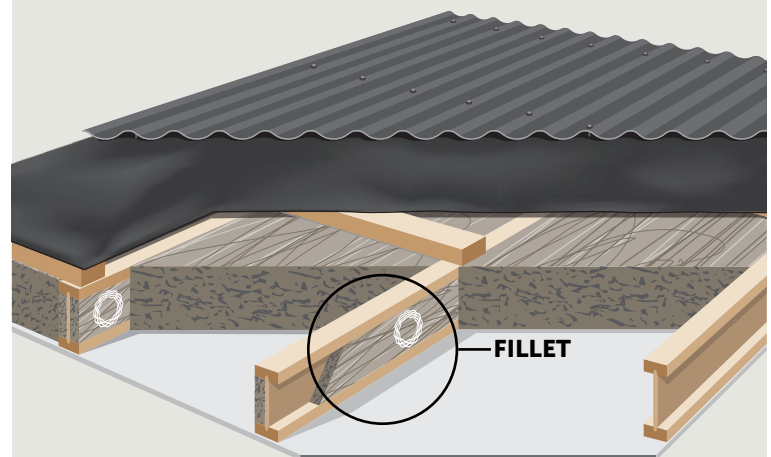

| Manufacturer | I-Beam Size | Fillet Size  |
|--------------|-------------|--------------|
| hyJOIST      | 200mm       | <b>120mm</b> |
| hyJOIST      | 240mm       | <b>160mm</b> |
| hyJOIST*     | 300mm       | <b>220mm</b> |
| Lumberworx*  | 200mm       | <b>140mm</b> |
| Lumberworx*  | 240mm       | <b>180mm</b> |
| Lumberworx*  | 300mm       | <b>240mm</b> |

### SPECIFICATIONS

| R-VALUE | BATTEN | JOIST SIZE           | SIZE IN BALE   | M <sup>2</sup> PER BALE | CODE       |
|---------|--------|----------------------|----------------|-------------------------|------------|
| R0.9    | 35mm   | <b>200mm hyJOIST</b> | 8 x 6m x 120mm | 48 lm/bale              | 09.35.120F |
| R0.9    | 35mm   | <b>240mm hyJOIST</b> | 7 x 6m x 160mm | 42 lm/bale              | 09.35.160F |

\* Other product fillets made to order—specify by fillet size, as per table above



0800 485 262 | [sales@terralana.co.nz](mailto:sales@terralana.co.nz) | [terralana.co.nz](http://terralana.co.nz)

# EXTERIOR WALL WOOL INSULATION

## PRODUCT DATA



TERRA LANA

The natural benefits of Terra Lana Wool designed for optimal exterior wall insulation

### APPLICATIONS

- External stud walls (& ceilings where applicable)
- New and retrofit
- Residential and commercial buildings

### FEATURES

- Designed to not slump or lose loft
- Superior insulative performance
- 100% recyclable (by Terra Lana)
- Easy to install, manufactured to fit
- Environmentally responsible product
- Naturally safe to handle & healthy in the home
- Manages moisture, maintaining thermal performance
- Excellent acoustic barrier qualities

### DESCRIPTION

Terra Lana Wool Wall Insulation is designed with rigidity to friction fit within exterior wall cavities and not slump or degrade over the life of the building.

### COMPLIANCE

- BRANZ APPRAISED. Appraisal 682 [2022]
- DECLARE RED LIST FREE. Certified toxin free
- GREENGUARD. Indoor air quality test approved
- HOMESTAR/GREENSTAR. Credits available
- EPD. (in process for mid 2024 completion)
- QUALITY ASSURANCE. 50 year warranty
- H1 COMPLIANT. Designed to meet/exceed

### SPEC ASSIST – Contact: [spec@terralana.co.nz](mailto:spec@terralana.co.nz)

- Masterspec
- Smart Spec
- Design Navigator
- H1 Reports & spec writing



### SPECIFICATIONS

| R-VALUE                    | THICKNESS | CENTRES | BALE CONTAINS     | M <sup>2</sup> PER BALE | CODE       |
|----------------------------|-----------|---------|-------------------|-------------------------|------------|
| <b>WALL SERVICE CAVITY</b> |           |         |                   |                         |            |
| R1.2                       | 45mm      | 600mm   | 2 x 5m x 570mm    | 5.70 m <sup>2</sup>     | 12.45.570  |
| <b>90MM WALL</b>           |           |         |                   |                         |            |
| R2.4                       | 90mm      | 400mm   | 10 x 1.2m x 360mm | 4.32 m <sup>2</sup>     | 24.90.360  |
| R2.4                       | 90mm      | 600mm   | 10 x 1.2m x 560mm | 6.72 m <sup>2</sup>     | 24.90.560  |
| <b>140MM WALL</b>          |           |         |                   |                         |            |
| R3.2                       | 140mm     | 400mm   | 10 x 1.2m x 360mm | 4.32 m <sup>2</sup>     | 32.140.360 |
| R3.2                       | 140mm     | 600mm   | 10 x 1.2m x 560mm | 6.72 m <sup>2</sup>     | 32.140.560 |
| R3.6                       | 140mm     | 400mm   | 10 x 1.2m x 360mm | 4.32 m <sup>2</sup>     | 36.140.360 |
| R3.6                       | 140mm     | 600mm   | 8 x 1.2m x 560mm  | 5.38 m <sup>2</sup>     | 36.140.560 |



0800 485 262 | [sales@terralana.co.nz](mailto:sales@terralana.co.nz) | [terralana.co.nz](http://terralana.co.nz)

# SERVICE CAVITY WOOL INSULATION

## PRODUCT DATA



TERRA LANA

The natural benefits of Terra Lana Wool Insulation designed to fill service cavities

### APPLICATIONS

- All ceiling and wall service cavities
- New and retrofit
- Residential and commercial buildings

### FEATURES

- Designed to not slump or lose loft
- Superior insulative performance
- Easy to install, manufactured to fit
- Environmentally responsible product
- Naturally safe to handle & healthy in the home
- Excellent acoustic barrier qualities

### DESCRIPTION

Terra Lana service cavity insulation is designed to fill service cavity spaces adding R-Value to the thermal envelope, while still allowing the passage of wiring and plumbing services.

### COMPLIANCE

- BRANZ APPRAISED. Appraisal 682 [2022]
- DECLARE RED LIST FREE. Certified toxin free
- GREENGUARD. Indoor air quality test approved
- HOMESTAR/GREENSTAR. Credits available
- EPD (in process for mid 2024 completion)
- QUALITY ASSURANCE. 50 year warranty

### SPEC ASSIST

- Masterspec
- Smart Spec
- Design Navigator
- H1 Reports & spec writing

Contact: [spec@terralana.co.nz](mailto:spec@terralana.co.nz)

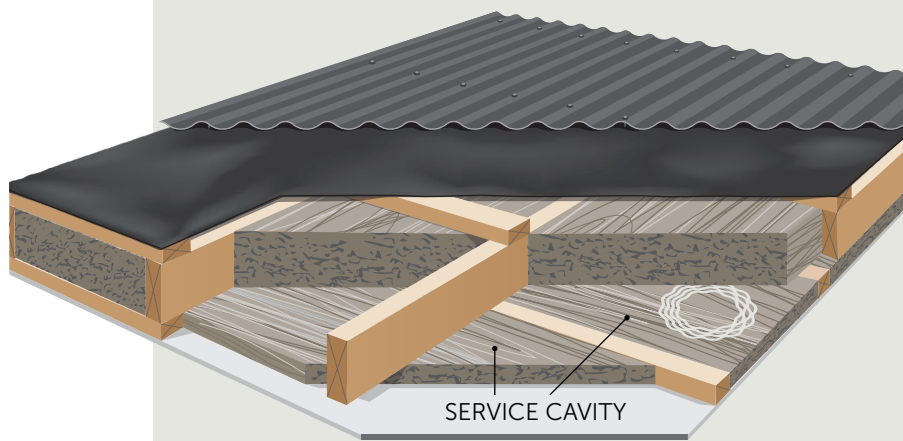

### SPECIFICATIONS

| R-VALUE                           | THICKNESS | CENTRES | DENSITY           | M <sup>2</sup> PER BALE | CODE      |
|-----------------------------------|-----------|---------|-------------------|-------------------------|-----------|
| CEILING SERVICE CAVITY INSULATION |           |         |                   |                         |           |
| R0.9                              | 35mm      | 600mm   | 2 x 6m x 570mm    | 6.84 m <sup>2</sup>     | 09.35.570 |
| R1.2                              | 45mm      | 600mm   | 2 x 5m x 570mm    | 5.70 m <sup>2</sup>     | 12.45.570 |
| R2.4                              | 90mm      | 600mm   | 10 x 1.2m x 560mm | 6.72 m <sup>2</sup>     | 24.90.560 |
| WALL SERVICE CAVITY INSULATION    |           |         |                   |                         |           |
| R1.2                              | 45mm      | 600mm   | 2 x 5m x 570mm    | 5.70 m <sup>2</sup>     | 12.45.570 |



0800 485 262 | [sales@terralana.co.nz](mailto:sales@terralana.co.nz) | [terralana.co.nz](http://terralana.co.nz)

# NEW BUILD DROP IN FLOOR WOOL INSULATION



TERRA LANA

## PRODUCT DATA

The natural benefits of Terra Lana Wool insulation designed for new suspended floors

### APPLICATIONS

- New lined and unlined timber suspended floors
- Retrofit, installed from above
- Non-enclosed or enclosed perimeter foundation floors
- Residential and commercial buildings

### FEATURES

- Designed to not slump or lose loft
- Superior insulative performance
- Easy to install, manufactured to fit
- Environmentally responsible product
- Naturally safe to handle & healthy in the home
- Proprietary installation system
- Excellent acoustic barrier qualities

### DESCRIPTION

Designed to be installed from above prior to sheet flooring, held by friction fit and Terra Lana's proprietary cradle-strap fastening system.

Terra Lana Drop In Floor Insulation is dense, semi-rigid and highly resistant to slumping, creating a wind-proof layer that fills the underfloor voids leaving no gaps.

The wool component provides optimal thermal insulation, while also transmitting moisture away from the building and remaining effective even in damp underfloor conditions.

Terra Lana is locally manufactured from predominantly natural and recycled materials and is safe and easy to handle, providing an overall product solution to meet modern environmental compliance demands.

### COMPLIANCE

- BRANZ APPRAISED. Appraisal 682 [2022]
- DECLARE RED LIST FREE. Certified toxin free
- GREENGUARD. Indoor air quality test approved
- HOMESTAR/GREENSTAR. Credits available
- EPD (in process for mid 2024 completion)
- QUALITY ASSURANCE. 50 year warranty

### SPEC ASSIST

- Masterspec
- Smart Spec
- Design Navigator
- H1 Reports & spec writing

Contact: [spec@terralana.co.nz](mailto:spec@terralana.co.nz)



### SPECIFICATIONS

| R-VALUE  | THICKNESS | CENTRES | BALE CONTAINS    | M <sup>2</sup> PER BALE | CODE        |
|--|-----------|---------|------------------|-------------------------|-------------|
| NEW BUILD DROP IN UNDERFLOOR – Install from above with propriety fastening system, prior to sheet flooring |           |         |                  |                         |             |
| R2.7   | 110mm     | 400mm   | 8 x 1.2m x 365mm | 3.50 m <sup>2</sup>     | DIF.110.365 |
| R3.2   | 140mm     | 400mm   | 8 x 1.2m x 365mm | 3.50 m <sup>2</sup>     | DIF.140.365 |



0800 485 262 | [sales@terralana.co.nz](mailto:sales@terralana.co.nz) | [terralana.co.nz](http://terralana.co.nz)



# RETROFIT UNDERFLOOR WOOL INSULATION



TERRA LANA

## PRODUCT DATA

The superior natural benefits of Terra Lana Wool insulation designed for underfloors

### APPLICATIONS

- Suspended floors, installed from the underside where there is a minimum 350mm clearance between the bearer and ground.
- Retrofit under existing floors only
- Residential and commercial buildings

### FEATURES

- Designed to not slump or lose loft
- Superior insulative performance
- 100% recyclable (by Terra Lana)
- Easy to install, manufactured to fit
- Environmentally responsible product
- Naturally safe to handle & healthy in the home
- Manages moisture, maintaining thermal performance
- Excellent acoustic barrier qualities

### DESCRIPTION

Designed to fill existing underfloor cavities with a durable, semi-rigid, high performance wool composition that is easy to install. The rigid structure prevents sagging, air movement and heat loss through gaps. The wool component transmits moisture vapour away from the building and maintains effectiveness in humid or damp conditions.

### COMPLIANCE

- BRANZ APPRAISED. Appraisal 682 [2022]
- DECLARE RED LIST FREE. Certified toxin free
- GREENGUARD. Indoor air quality test approved
- HOMESTAR/GREENSTAR. Credits available
- EPD (in process for mid 2024 completion)
- QUALITY ASSURANCE. 50 year warranty

### SPEC ASSIST

- Masterspec
- Smart Spec
- Design Navigator
- H1 Reports & spec writing

Contact: [spec@terralana.co.nz](mailto:spec@terralana.co.nz)

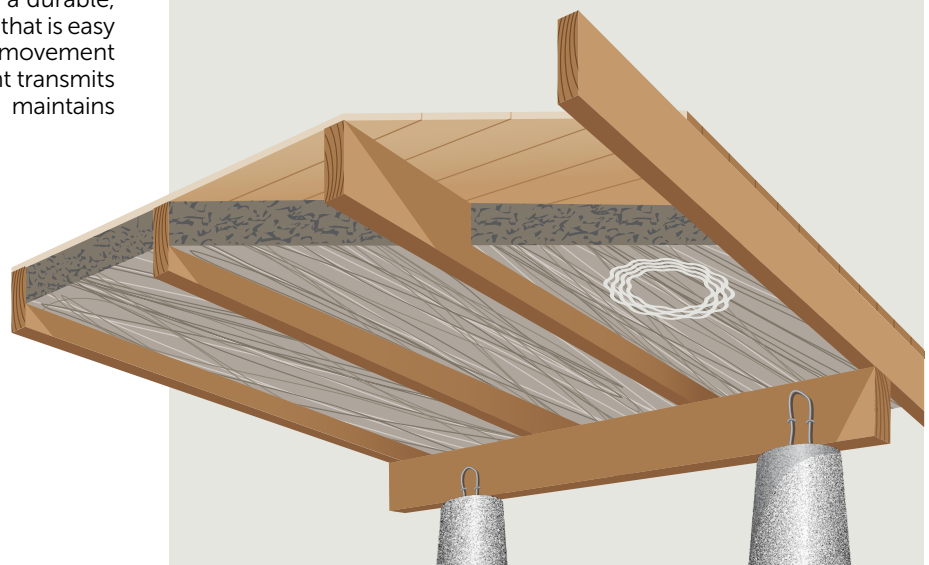

### SPECIFICATIONS

| R-VALUE               | THICKNESS | CENTRES | BALE CONTAINS    | M <sup>2</sup> PER BALE | CODE       |
|-----------------------|-----------|---------|------------------|-------------------------|------------|
| UNDERFLOOR INSULATION |           |         |                  |                         |            |
| R2.0                  | 115mm     | 450mm   | 2 x 5.6m x 480mm | 5.38 m <sup>2</sup>     | 20.115.480 |



0800 485 262 | [sales@terralana.co.nz](mailto:sales@terralana.co.nz) | [terralana.co.nz](http://terralana.co.nz)

# CHATTERBLOCK® WOOL ACOUSTIC INSULATION



TERRA LANA

## PRODUCT DATA

The benefits of Terra Lana wool's premium performance designed to block out noise

### APPLICATIONS

- Inter-tenancy walls and floors **including GIB Systems** (see next page)
- Residential and commercial buildings
- Internal walls & midfloors between living areas.

### FEATURES

- Designed to not slump or lose loft
- Superior insulative performance
- 100% recyclable (by Terra Lana)
- Easy to install, manufactured to fit
- Environmentally responsible product
- Naturally safe to handle & healthy in the home
- Manages moisture, maintaining thermal performance
- Excellent acoustic barrier qualities

### DESCRIPTION

Terra Lana Chatterblock® leverages on wool's outstanding sound absorbing qualities. The semi-rigid construction is specifically formulated with a high density of at least 18kg/m<sup>3</sup>, giving a high flow resistance suitable for a wide range of specialised sound control.

Chatterblock® is locally manufactured from sheep wool from Canterbury farms and is safe to handle and easy to friction fit install, providing a solution that meets modern acoustic and environmental compliance standards.

### COMPLIANCE

- BRANZ APPRAISED. Appraisal 682 [2022]
- DECLARE RED LIST FREE. Certified toxin free
- GREENGUARD. Indoor air quality test approved
- HOMESTAR/GREENSTAR. Credits available
- EPD (in process for mid 2024 completion)
- QUALITY ASSURANCE. 50 year warranty

### SPEC ASSIST

- Masterspec
- Smart Spec
- Design Navigator
- H1 Reports & spec writing

Contact: [spec@terralana.co.nz](mailto:spec@terralana.co.nz)

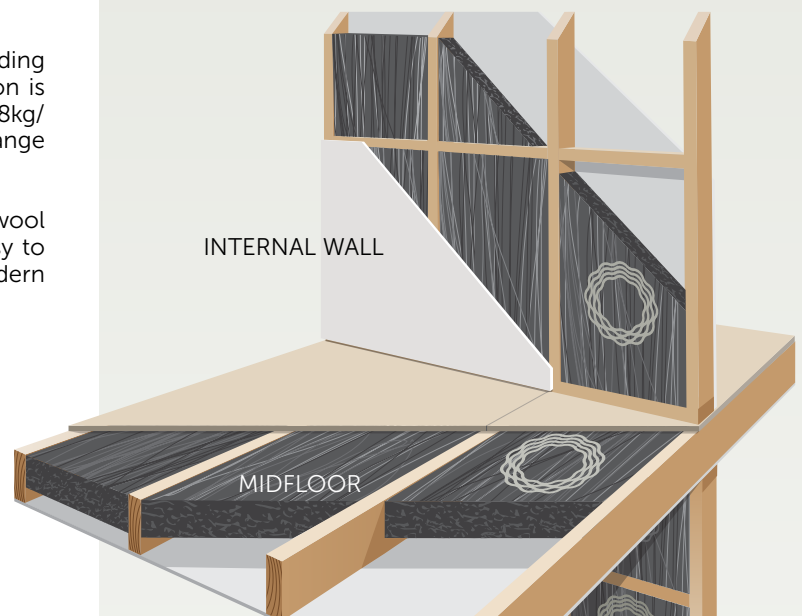

### SPECIFICATIONS

| R-VALUE  | THICKNESS | CENTRES | DENSITY                | M <sup>2</sup> PER BALE | CODE       |
|--|-----------|---------|------------------------|-------------------------|------------|
| CHATTERBLOCK® ACOUSTIC INSULATION – For internal walls and midfloors |           |         |                        |                         |            |
| R1.4   | 60mm      | 600mm   | 46.7 kg/m <sup>3</sup> | 8.06 m <sup>2</sup>     | CB.60.560  |
| R2.2   | 90mm      | 600mm   | 21.8 kg/m <sup>3</sup> | 8.06 m <sup>2</sup>     | CB.90.560  |
| R3.2   | 140mm     | 600mm   | 18.2 kg/m <sup>3</sup> | 6.72 m <sup>2</sup>     | CB.140.560 |



0800 485 262 | [sales@terralana.co.nz](mailto:sales@terralana.co.nz) | [terralana.co.nz](http://terralana.co.nz)

GIB SYSTEM SOUND TRANSMISSION CLASS PRODUCT SPECIFICATIONS

| GIB SPECIFICATION  | STC* | GIB SPECIFICATION   | STC* |
|--|------|---|------|
| Central barrier walls<br>Timber frame walls – with GIB Barrierline central barrier |      | Steel frame walls – GIB Rail and acoustic resilient mount |      |
|  |      | GBSA 30r  | 55   |
| GBTLAB 60a   | 68   | GBSA 60r  | 55   |
| GBTLAB 60b   | 64   | GBSA 90r  | 57   |
| GBTLAB 60c   | 67   | GBSIC 45a   | 55   |
| GBTLAB 60d   | 61   | Staggered steel stud walls                                |      |
| Steel frame walls – with GIB Barrierline central barrier                           |      | GBSA 30s  | 55   |
| GBSAB 60a  | 63   | GBSA 90s  | 60   |
| GBSAB 60b  | 67   | GIB Rondo Quiet Stud                                      |      |
| GBSAB 60c  | 68   | GBQSA 45  | 56   |
| Staggered stud steel frame walls – with 13mm GIB Fyreline central barrier          |      | GBQSA 60a   | 55   |
|  |      | GBQSA 90  | 58   |
| GBSAB 60d  | 56   | Floor/ceiling and suspended grid<br>Floor/ceiling systems |      |
| GBSAB 60e  | 57   |   |      |
| Double frame walls<br>Double timber frame walls                                    |      | GBDFA 60b   | 57   |
|  |      | GBDFA 60d   | 67   |
| GBTLA 30a  | 56   | GBDFA 60e   | 65   |
| GBTLA 30b  | 56   | GBSJA 45  | 55   |
| GBTLA 60   | 58   | GBSJA 60  | 56   |
| GBTLA 90c  | 60   | Suspended grid systems                                    |      |
| GBTLA 90d  | 64   | GBSCA 45  | 56   |
| Double steel frame walls   |      | GBSCA 60a   | 56   |
| GBSA 30b   | 54   |   |      |
| GBSA 60c   | 58   |   |      |
| GBSA 45  | 59   |   |      |
| GBSA 90c   | 60   |   |      |
| GBSA 90d   | 64   |   |      |
| GBTLA 90r  | 55   |   |      |
| GBTLIC 45  | 61   |   |      |
| GBTLIC 60  | 62   |   |      |
| GBTLIC 60a   | 57   |   |      |

\*Sound Transmission Class

the rating for how well a partition attenuates sound. Higher numbers denote a greater reduction of sound.

0800 485 262

spec@terralana.co.nz | terralana.co.nz

55 Francella St, Christchurch, NZ



TERRALANA

