

# CHATTERBLOCK® WOOL ACOUSTIC INSULATION



TERRA LANA

## PRODUCT DATA

The benefits of Terra Lana wool's premium performance designed to block out noise

### APPLICATIONS

- Inter-tenancy walls and floors **including GIB Systems** (see next page)
- Residential and commercial buildings
- Internal walls & midfloors between living areas.

### FEATURES

- Designed to not slump or lose loft
- Superior insulative performance
- 100% recyclable (by Terra Lana)
- Easy to install, manufactured to fit
- Environmentally responsible product
- Naturally safe to handle & healthy in the home
- Manages moisture, maintaining thermal performance
- Excellent acoustic barrier qualities

### DESCRIPTION

Terra Lana Chatterblock® leverages on wool's outstanding sound absorbing qualities. The semi-rigid construction is specifically formulated with a high density of at least 18kg/m<sup>3</sup>, giving a high flow resistance suitable for a wide range of specialised sound control.

Chatterblock® is locally manufactured from sheep wool from Canterbury farms and is safe to handle and easy to friction fit install, providing a solution that meets modern acoustic and environmental compliance standards.

### COMPLIANCE

- BRANZ APPRAISED. Appraisal 682 [2022]
- DECLARE RED LIST FREE. Certified toxin free
- GREENGUARD. Indoor air quality test approved
- HOMESTAR/GREENSTAR. Credits available
- EPD (in process for mid 2024 completion)
- QUALITY ASSURANCE. 50 year warranty

### SPEC ASSIST

- Masterspec
- Smart Spec
- Design Navigator
- H1 Reports & spec writing

Contact: [spec@terralana.co.nz](mailto:spec@terralana.co.nz)

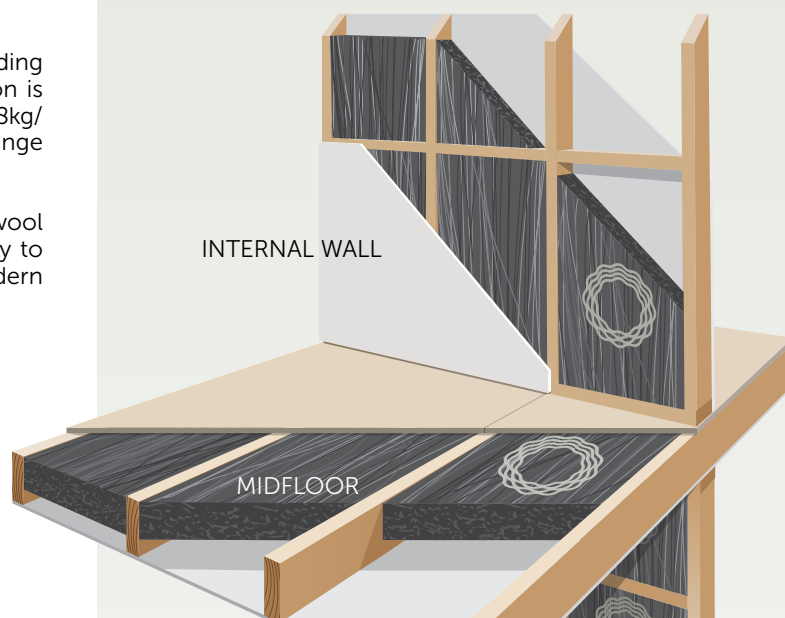

### SPECIFICATIONS

R-VALUE	THICKNESS	CENTRES	DENSITY	M <sup>2</sup> PER BALE	CODE
CHATTERBLOCK® ACOUSTIC INSULATION – For internal walls and midfloors					
R1.4	60mm	600mm	46.7 kg/m <sup>3</sup>	8.06 m <sup>2</sup>	CB.60.560
R2.2	90mm	600mm	21.8 kg/m <sup>3</sup>	8.06 m <sup>2</sup>	CB.90.560
R3.2	140mm	600mm	18.2 kg/m <sup>3</sup>	6.72 m <sup>2</sup>	CB.140.560



0800 485 262 | [sales@terralana.co.nz](mailto:sales@terralana.co.nz) | [terralana.co.nz](http://terralana.co.nz)

GIB SYSTEM SOUND TRANSMISSION CLASS PRODUCT SPECIFICATIONS

GIB SPECIFICATION	STC*	GIB SPECIFICATION	STC*
Central barrier walls Timber frame walls – with GIB Barrierline central barrier		Steel frame walls – GIB Rail and acoustic resilient mount	
		GBSA 30r	55
GBTLAB 60a	68	GBSA 60r	55
GBTLAB 60b	64	GBSA 90r	57
GBTLAB 60c	67	GBSIC 45a	55
GBTLAB 60d	61	Staggered steel stud walls	
Steel frame walls – with GIB Barrierline central barrier		GBSA 30s	55
GBSAB 60a	63	GBSA 90s	60
GBSAB 60b	67	GIB Rondo Quiet Stud	
GBSAB 60c	68	GBQSA 45	56
Staggered stud steel frame walls – with 13mm GIB Fyreline central barrier		GBQSA 60a	55
		GBQSA 90	58
GBSAB 60d	56	Floor/ceiling and suspended grid Floor/ceiling systems	
GBSAB 60e	57		
Double frame walls Double timber frame walls		GBDFA 60b	57
		GBDFA 60d	67
GBTLA 30a	56	GBDFA 60e	65
GBTLA 30b	56	GBSJA 45	55
GBTLA 60	58	GBSJA 60	56
GBTLA 90c	60	Suspended grid systems	
GBTLA 90d	64	GBSCA 45	56
Double steel frame walls		GBSCA 60a	56
GBSA 30b	54		
GBSA 60c	58		
GBSA 45	59		
GBSA 90c	60		
GBSA 90d	64		
GBTLA 90r	55		
GBTLIC 45	61		
GBTLIC 60	62		
GBTLIC 60a	57		

\*Sound Transmission Class

the rating for how well a partition attenuates sound. Higher numbers denote a greater reduction of sound.

0800 485 262

spec@terralana.co.nz | terralana.co.nz

55 Francella St, Christchurch, NZ

